

EXPLODED VIEW

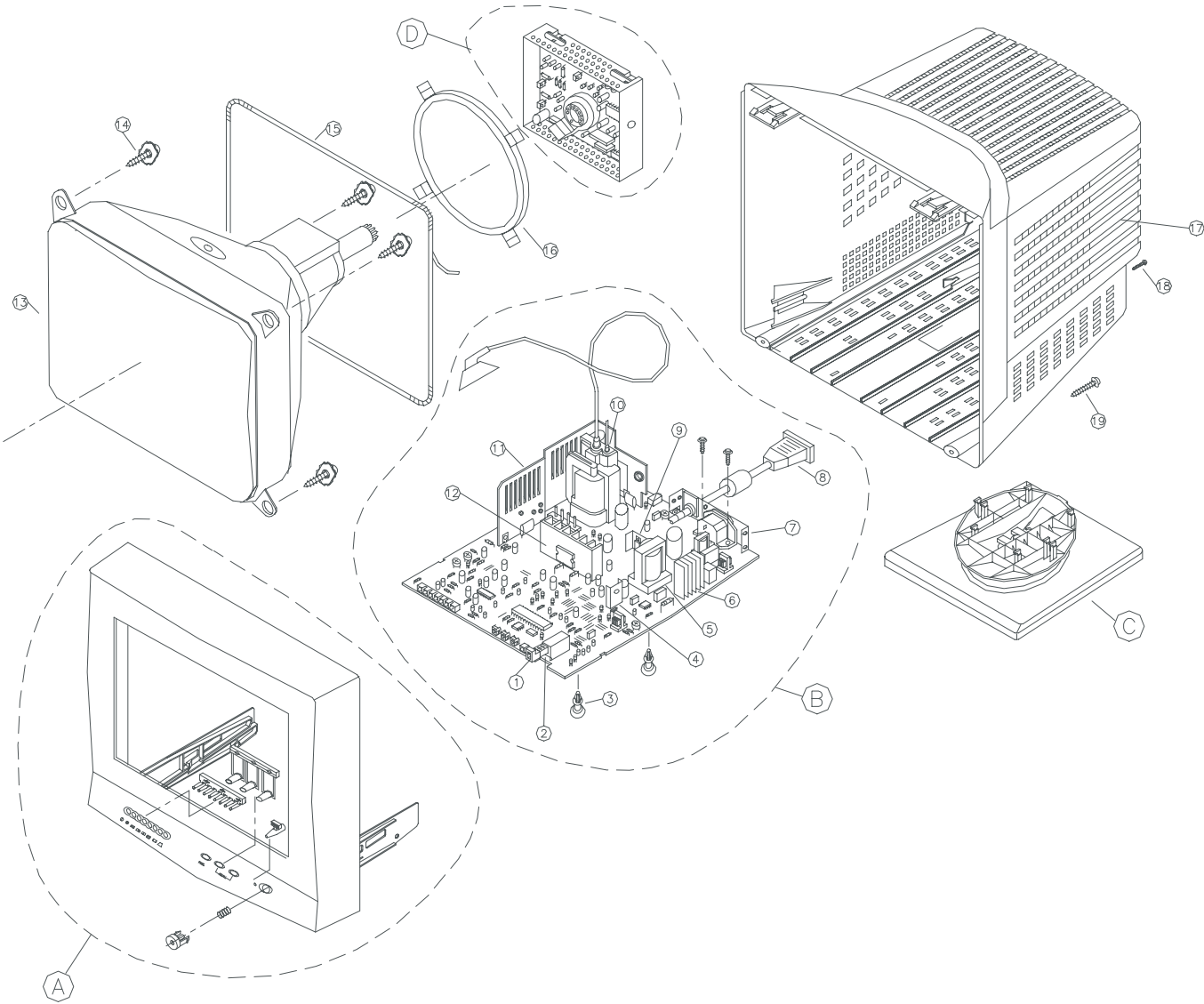

No.	Part No.	description	Q'ty	Remark
1	33A35981	ABS PLASTIC	1	
2	77A267-12	POWER SWITCH	1	
3	11A121-500	PCB SUPPORT	2	
4	90A315-1	HEAT SINK(IC904)	1	
5	80A356N1-LA	POWER TRANSFORMOR(T901)	1	
6	90A339-2-A	HEAT SINK (Q901)	1	
7	15A5643501	REAR BRACKET	1	
8	89A173E5CB	SIGNAL CABLE	1	
9	90A315-1	HEAT SINK Q911	1	
10	79A355-4-A	FBT(T402)	1	
11	90A354-509	HEAT SINK(D408/Q403/Q406)	1	
12	90A348-2	HEAT SINK(IC601)	1	
13	X0A5640***	CRT	1	REFER TO TABLE 1
14	1A503-1-47	SCREW	4	
15	X0A16971-GD	DEGAGSSING COIL	1	
16	X0A1697503	ROTATION COIL	1	
17	0A45V-B*	BACK COVER ASS'Y	1	REFER TO TABLE 1
18	B1A1035-10	SCREW #3.5*10	1	
19	Q1A340-16	SCREW #4*16	2	
A	0A45V-F*	FRONT ASS'Y	1	REFER TO TABLE 1
B	CM45V****	MAIN BOARD ASS'Y	1	REFER TO TABLE 1
C	0A45V-S*	BASE ASS'Y	1	REFER TO TABLE 1
D	CR45V1	CRT BOARD ASS'Y FOR LGE 45V	1	

LGE 45V Different Parts List

Table 1

Destination	Nation	Model	Front Bezel Ass'y	Back Cover Ass'y	Main Board Ass'y	CRT/GAUSS	Power Cord P/N	Power Cord Type	Base Ass'y
Central/South America	Mexico	D356NQCOLDMDM	0A45V-F1	0A45V-B1	CM45V2C1N1	X0A5640-2AS Mexico	89A402E15Y	USA W-OUT	0A45V-S1
	Panama Peru	D356NQAKLMDE	0A45V-F1	0A45V-B1	CM45V1C2N1	X0A5640-2GC Lima	89A402E15Y	USA W-OUT	0A45V-S1
Africa	S. Africa	D356N1C7LMDE	0A45V-F2	0A45V-B2	CM45V2C1S1	X0A5640-2AS Johannesburg	89A502E15N	PC-OUT	0A45V-S2
	Egypt	D356N1ABLXDE	0A45V-F2	0A45V-B2	CM45V2C1S1	X0A5640-2GC Egypt	89A404E15N	Europe W-OUT	0A45V-S2
Asia	India	D356N1CCLSDE	0A45V-F2	0A45V-B2	CM45V2C1N2	X0A5640-2AS New Delhi	89A404E15N	Europe W-OUT	0A45V-S2
	Indonesia	D356N1CCLIDE	0A45V-F2	0A45V-B2	CM45V2C1N1	X0A5640-2AS Indonesia	89A502E15N	PC-OUT	0A45V-S2
	Vietnam	D356NQCCLYDE	0A45V-F2	0A45V-B2	CM45V2C1N1	X0A5640-2AS Vietnam	89A502E15N	PC-OUT	0A45V-S2
Australia	Australia	D356NQCCLLMDE	0A45V-F2	0A45V-B2	CM45V2C1S1	X0A5640-2AS Australia	89A502E15N	PC-OUT	0A45V-S2
Middle East	U.A.E	D356N1CWLXDE	0A45V-F2	0A45V-B2	CM45V2C1N1	X0A5640-2AS Egypt (A.U.E, Syria, Lebanon)	89A502E15N	Europe W-OUT	0A45V-S2
	Lebanon								
	Syria								
	Pakistan	D356NQCCLMDE	0A45V-F2	0A45V-B2	CM45V2C1N1	X0A5640-2AS Hong Kong	89A404E15N	Europe W-OUT	0A45V-S2
	Saudi Arabia								
Europe	Belgium	D356N1CWLXDE	0A45V-F2	0A45V-B2	CM45V2C1N1	X0A5640-2AS Belgium	89A502E15N	Europe W-OUT	0A45V-S2